

LightCue Pro™

4 Universe DMX Recorder with Ethernet Control
Model LIGHTCUE PRO



LIGHTING CONTROL

Why leave an expensive lighting console in a permanent install? The LightCue Pro DMX Recorder captures up to 4 Universes and plays them back perfectly every time.

FEATURES:

- ▶ Parallel, SMPTE, Serial, & Ethernet Control
- ▶ Records output of any lighting board
- ▶ Stores at least 100 hours of DMX data
- ▶ Can “pile-on” up to 40 simultaneous cues
- ▶ Switch between “live” DMX input and recorded material
- ▶ Stand alone or controller driven operation
- ▶ Real Time Clock

APPLICATIONS:

- ▶ Architectural Lighting
- ▶ Multi-room Venues
- ▶ Dark Rides
- ▶ Venues with Moving Fixtures

The LightCue Pro is a multi-universe DMX recorder/player engineered for the unique requirements of the permanent install and architectural lighting applications.

LightCue Pro is designed to replace bulky and expensive lighting consoles. Simply use your favorite lighting console to program your lighting as you would normally. Then, record the DMX output of your console into the LightCue Pro. Take the console away and you are ready to go!

The LightCue Pro can be controlled via Ethernet, RS-232, SMPTE timecode, contact closure/voltage inputs, cue lists or the real-time scheduler (including sunrise/sunset). You can even pile-on up to 40 cues at one time for complex shows/rides. With no moving parts, the LightCue Pro will run for years without any maintenance.

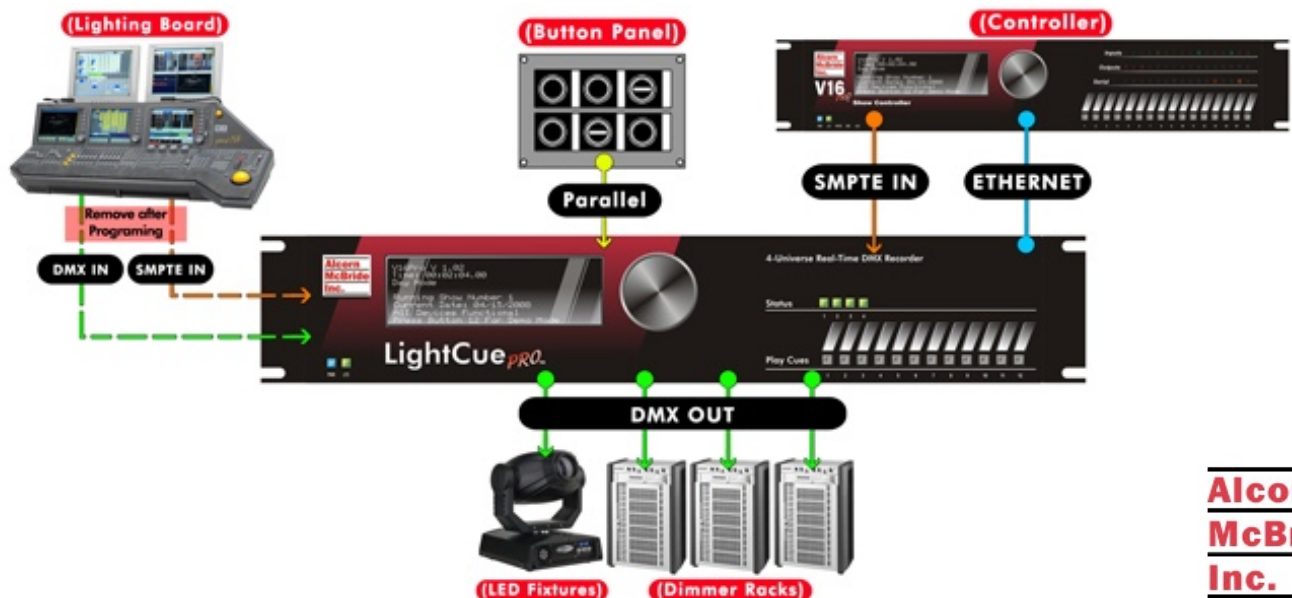

**Alcorn
McBride
Inc.**

LightCue Pro™

4 Universe DMX Recorder
Model LIGHTCUE PRO



LIGHTING CONTROL

PRODUCT SPECIFICATIONS

DMX

Input:	(4) Male 5-Pin XLR
Output:	(4) Female 5-Pin XLR
Signal:	Fully DMX-512/1990 Compliant
Recorded Channels:	(4x) 512
Playback Time:	At least 100 hours (with every channel changing 30 times per second)

Control Interface

Serial:	RS-232C at 9600 baud, n, 8, 1
Ethernet:	(2x) 100 Base-T, UDP control HTTP FTP File Transfer
MIDI:	MIDI Command Control
USB:	USB 2.0 Control
Parallel Opto Inputs:	Programmable: Play any cue, Still, Stop, Record, Pile-on, Feedthrough, and Loop
Parallel Contact Outputs:	(4) Running, (4) Fault
SMPTE Inputs:	Female 3-Pin XLR, transfer coupled 600 ohm
Real Time Clock:	Battery Backed-up

Front Panel

Pushbuttons:	12 direct cue trigger pushbuttons
Knob:	Menu Selection, Record, Play, Still, Stop and Set Up
Indicators:	SMPTE Lock, Power, 4 Playing/Recording status
VFD Display:	8 lines, 42 characters per line
CF Socket:	Rear accessible, security cover plate

Physical

Power:	100 to 250 VAC, 50/60 Hz, 20 watts maximum Class 2 Supply Provided
Size:	19" W x 3.5" H x 10.6" D (48.3 cm W x 8.8 cm H x 26.9 cm D)
Weight:	17 lbs. (7.7 Kg)
Environment:	0°C (32°F) to 38°C (100°F) 0-90% Relative Humidity
Power Supply Compliance:	CE, UL, CSA, WEEE, RoHS

**Alcorn
McBride
Inc.**